



## The ultimate all-in-one solution

Chicago Pneumatic introduced the CPA-CPB Series more than a decade ago. And in this period of time a strong reputation of quality and top performance was built. But, apart from this remarkable past, the design and philosophy have evolved to match new customer needs: a beautiful all-in-one, powerful and silent screw compressor. That's what the CPA-CPB Series is!

A seamless product in terms of user-friendliness, reliability and life duration, which makes this series, "the screw compressor" for tough and hard working conditions.



**CPA 20 - 500L**

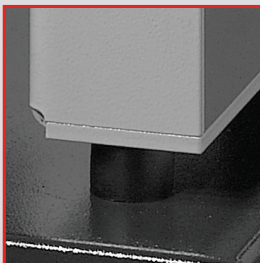

**Low noise levels**

Insulation foam, deflectors and anti-vibration pads assure low noise levels.



**Easy and fast maintenance**

Enabled by good positioning of service items: belts, oil and filters.



**ES3000**

A unique control unit, specially programmed for energy saving.

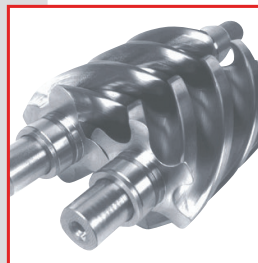

**Built to last**

Designed for continuous duty and very hard working conditions.



**Small footprint**

Compresses, stores and processes air using just 1,5 m<sup>2</sup>.

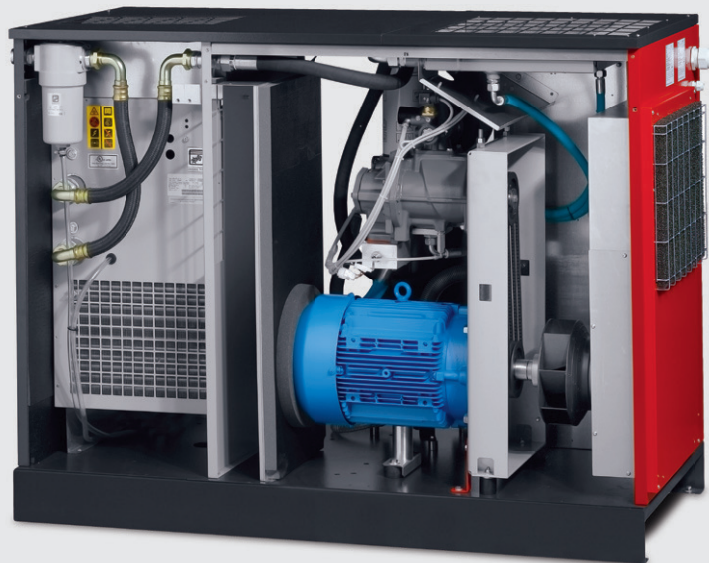

### Innovative design concept

The CPA-CPB Series can be configured as an ultimate all-in-one solution that includes:

- Air receiver 270 or 500L (available for units up to 30HP)
- Refrigerant dryer
- Automatic drain
- Line filter

Forget about complex and costly installations. Simply connect the power, connect the piping and press START!

Technical Table	🔌 [l/min]			🏠		🔊	⏪
Type	8 bar version	10 bar version	13 bar version	HP	kW	dB(A)	L x W x H (mm)
CPA Base mounted							(+ Dryer )
CPA 7*	820	670	520	7,5	5,5	66	1095 x 642 x 1070 (1095 x 642 x 1070)
CPA 10*	1153	1000	810	10	7,5	66	1095 x 642 x 1070 (1095 x 642 x 1070)
CPA 15*	1665	1435	1210	15	11	69	1095 x 642 x 1070 (1095 x 642 x 1070)
CPA 20*	1985	1771	1480	20	15	69	1095 x 642 x 1070 (1095 x 642 x 1070)
* Tankmounted models are available on 270 and 500 L vessels							
CPB Base mounted							(+ Dryer )
CPB 15**	1726	1492	1121	15	11	70	1095 x 642 x 1070 (1095 x 642 x 1070)
CPB 20**	2218	2020	1538	20	15	70	1095 x 642 x 1070 (1095 x 642 x 1070)
CPB 25**	2771	2501	1959	25	18,5	72	1204 x 805 x 1220 (1659 x 805 x 1220)
CPB 30**	3511	3011	2612	30	22	74	1205 x 805 x 1220 (1659 x 805 x 1220)
CPB 40	3893	3502	2942	40	30	77	1206 x 805 x 1220 (1659 x 805 x 1220)
** Tankmounted models are available on a 500 L vessel							

For weights and part numbers please contact your local customer center

All units are also available in 60Hz, please contact your local sales representative for more information.