

HALF MOON RING SPANNERS



EGA Master Half Moon Ring Spanners are **ideal**, thanks to their shape, to operate with nuts where conventional spanner is inaccessible.

1. Thanks to their **C-shaped design**, they can be used in hard to reach places, such as in the intake and exhaust valves, starter motors and engine heads.



2. The configuration of the ring is **12 edges**.

3. Manufactured from **chrome-vanadium** steel, this wrench is designed to support high torque values without breaking, providing increased durability.

4. Manufactured according to **DIN 475** standard.



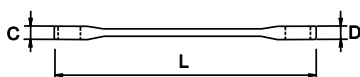

HALF MOON RING SPANNERS MM

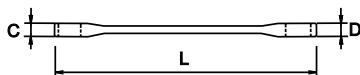

COD.	L (mm)	AF (mm)	A (mm)	B (mm)	C (mm)	D (mm)	g		
57158	135	6-8	15	19	8,0	8,0	55		
57159		8-10							
60795	150	11-13	20	23	9,0	9,0	90		
57160	175	13-15					110		
60796		13-17					120		
57161	185	14-16	25	28	10	10	160	10	•
60797		14-17							
57162	210	17-19	28	31	11	11	210		
60798		19-22	31				280		
57163	230	21-22	32	35	12	12	300		

HALF MOON RING SPANNERS INCHES



COD.	L (mm)		A (mm)	B (mm)	C (mm)	D (mm)			
57148	135	1/4- 5/16	15	19	8,0	8,0	55	10	●
57149		5/16- 3/8							
57150	155	7/16- 1/2	20	23	9,0	9,0	90		
57151	185	9/16- 5/8	25	28	10	10	160		
57152	210	11/16- 3/4	28	31	11	11	210		
57153	230	13/16- 7/8	32	35	12	12	300		

TECHNICAL SPECIFICATIONS	
MATERIAL	Cr-V
HARDNESS	44-50 HRc
FINISHING	Aerospatial chrome plating

